

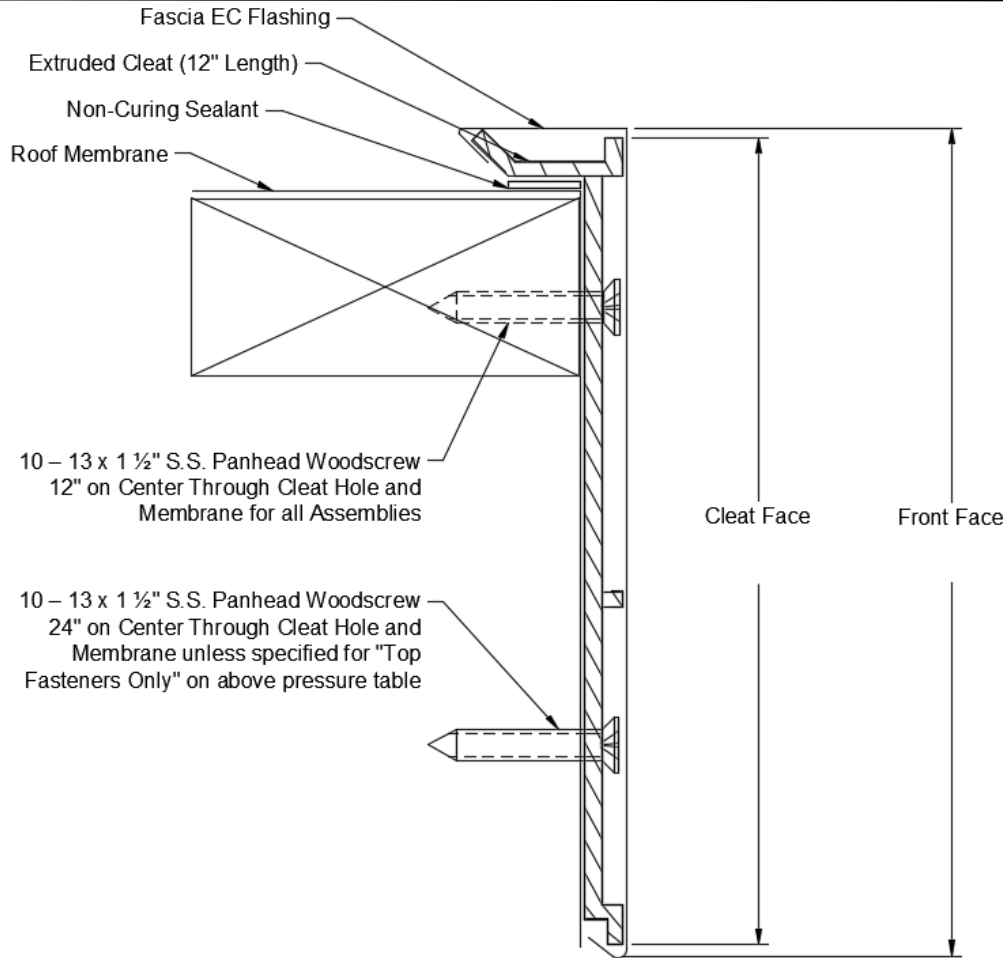

ANSI/SPRI ES-1 CERTIFIED –

.040"AL = 340 psf, .032"AL = 430 psf, 24GA = 300 psf (8 ½" Max. Face)\*

.050"AL = 160 psf, 22GA = 160 psf (10" & 11 ½" Face)\*



\*Contact Instinctive Metals on ES-1 Certification\*

### Material Type

24 GA

22 GA

.032" AL

.040" AL

.050" AL

Other:

**Finish:**

**Color:**

**Roof Material:**

**Membrane Thickness:**

**Substrate:**

Wood

Masonry

Metal

### Quantities and Configurations:

Linear Feet (10'-0" Lengths): \_\_\_\_\_

Outside Miters: \_\_\_\_\_

Inside Miters: \_\_\_\_\_

Right End Caps: \_\_\_\_\_

Left End Caps: \_\_\_\_\_

### Project Details:

Project Name: \_\_\_\_\_

Project Location: \_\_\_\_\_

Contractor: \_\_\_\_\_

### Warranty:

Check this box if manufacturer warranty is required

### Print Approval:

By checking this box, you confirm that the dimensions, sizes, and quantities are accurate.

Date: \_\_\_\_\_